

# PASCAL QUICK MOLD CHANGE SYSTEM PROMISES

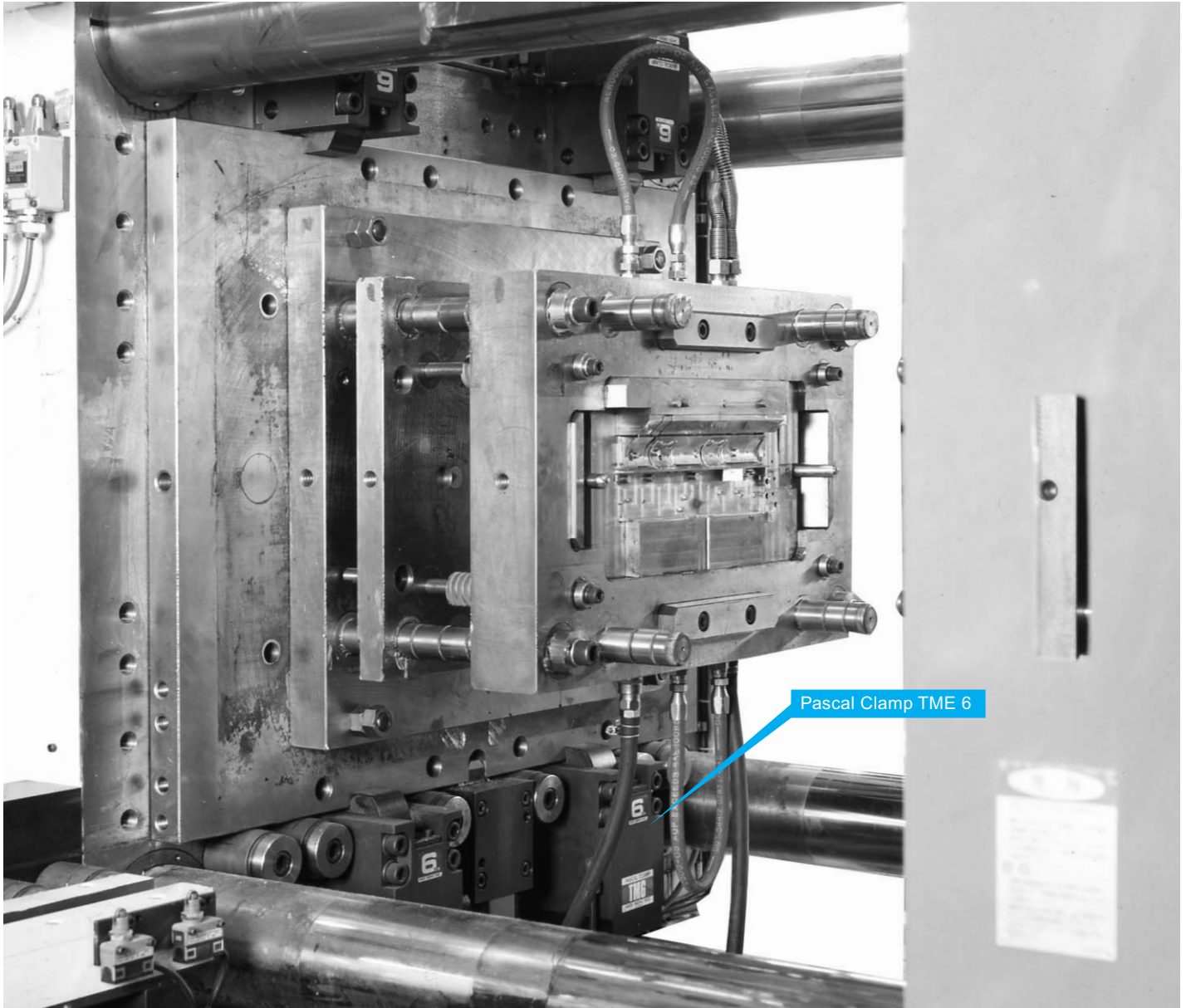

Pascal Clamp TME 6

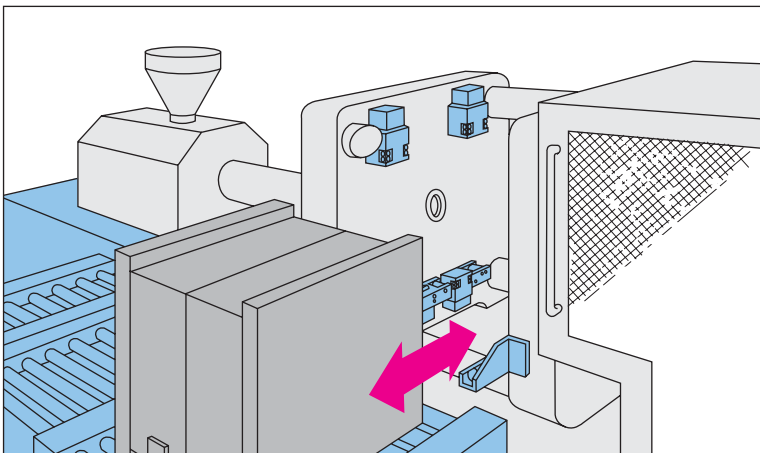

**PASCAL** Horizontal Mold Change System has been developed for quicker and safer mold changing operation than the Vertical Mold Change System. It can eliminate the use of the crane during mold change operation, this idle time or down time of injection machines due to crane availability can be omitted.

# SUBSTANTIAL REDUCTION OF MACHINE DOWN-TIME

## PASCAL HORIZONTAL MOLD CHANGE

### SYSTEM IHM (IHK)

**MODEL TME** (small-medium size machine)

**MODEL TKB** (Large size machine)

**Small-medium size Mold Change System**

**Medium-large size Mold Change System**

## SELECTION OF CLAMP SYSTEM

Injection Molding Machine		System IHM · IHK (TME · TKB clamp)		Mold Roller	Positioning Cylinder	U-cut dimensions		U-cut dimensions for positioning
Mold clamp Force (kN)	Mold opening Force (kN)	Model × No. Req.	Applicable Control Unit			m (mm)	n (mm)	
~ 500	39.2	TME1 × 8	HCFD-3CSS	CR- 20K	MHP1	30 <sup>+0.1</sup>	26	
~ 1000	98.0	TME2.5 × 8	HCFD-3CSS					
~ 2000	156	TME4 × 8	HCFD-3CSS	CR- 40K	MHP2	45 <sup>+0.1</sup>	32	
~ 3500	247	TME6 × 8	HCFD-3CSS					
~ 4500	392	TME10 × 8	HCFD-3CSS	CR- 60K	MHP3	60 <sup>+0.1</sup>	38	
~ 5500			HCFD-3CSS					
~ 6500	627(392)	TME16(TME10) × 8	HCE50-3LRLR	CR- 80K	MHP4	80 <sup>+0.1</sup>	38	
~ 8500	627	TME16(TKB16) × 8		CR- 100K				
~ 10000	980 (627)	TKB25 (TKB16) × 8		CR- 120K				
~ 13000	980	TKB25 × 8		CR- 160K				
~ 20000				CR- 180K				
~ 25000	1569	TKB40 × 8						
~ 30000								

※Above mold opening forces are for reference. Inquire the clamp selection, when the actual mold opening force is greater than above value.